

**** 1:1 SLOPE LOCATIONS**

(STA 22+50 - 23+50 LT)
(STA 28+50 - 30+00 LT)
(STA 62+50 - 64+00 LT)
(STA 98+50 - 101+00 RT)
(STA 112+50 - 114+50 LT)
(STA 136+00 - 137+50 LT)
(STA 168+50 - 171+00 RT)
(STA 184+50 - 186+50 RT)
(STA 271+50 - 273+00 LT)
(STA 320+50 - 321+50 RT)
(STA 330+50 - 332+50 RT)
(STA 333+00 - 336+00 RT)
(STA 346+00 - 347+00 RT)

- (STA 19+00 - 21+00)
- (STA 92+00 - 94+00)
- (STA 128+50 - 129+50)
- (STA 157+00 - 162+00)
- (STA 182+50 - 184+00)
- (STA 218+50 - 224+00)
- (STA 421+00 - 423+00)
- (STA 490+50 - 501+00)
- (STA 506+00 - 509+50)

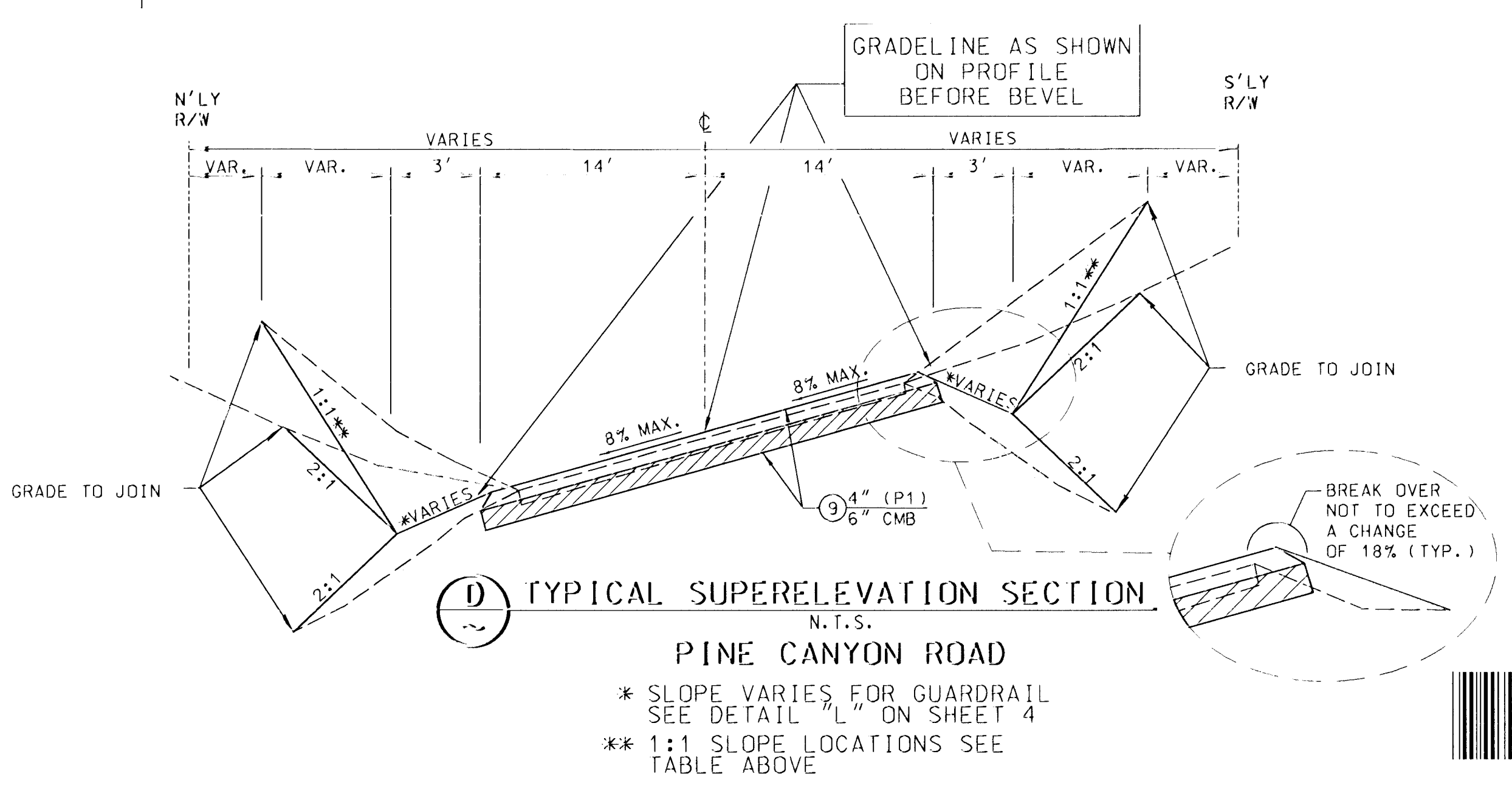
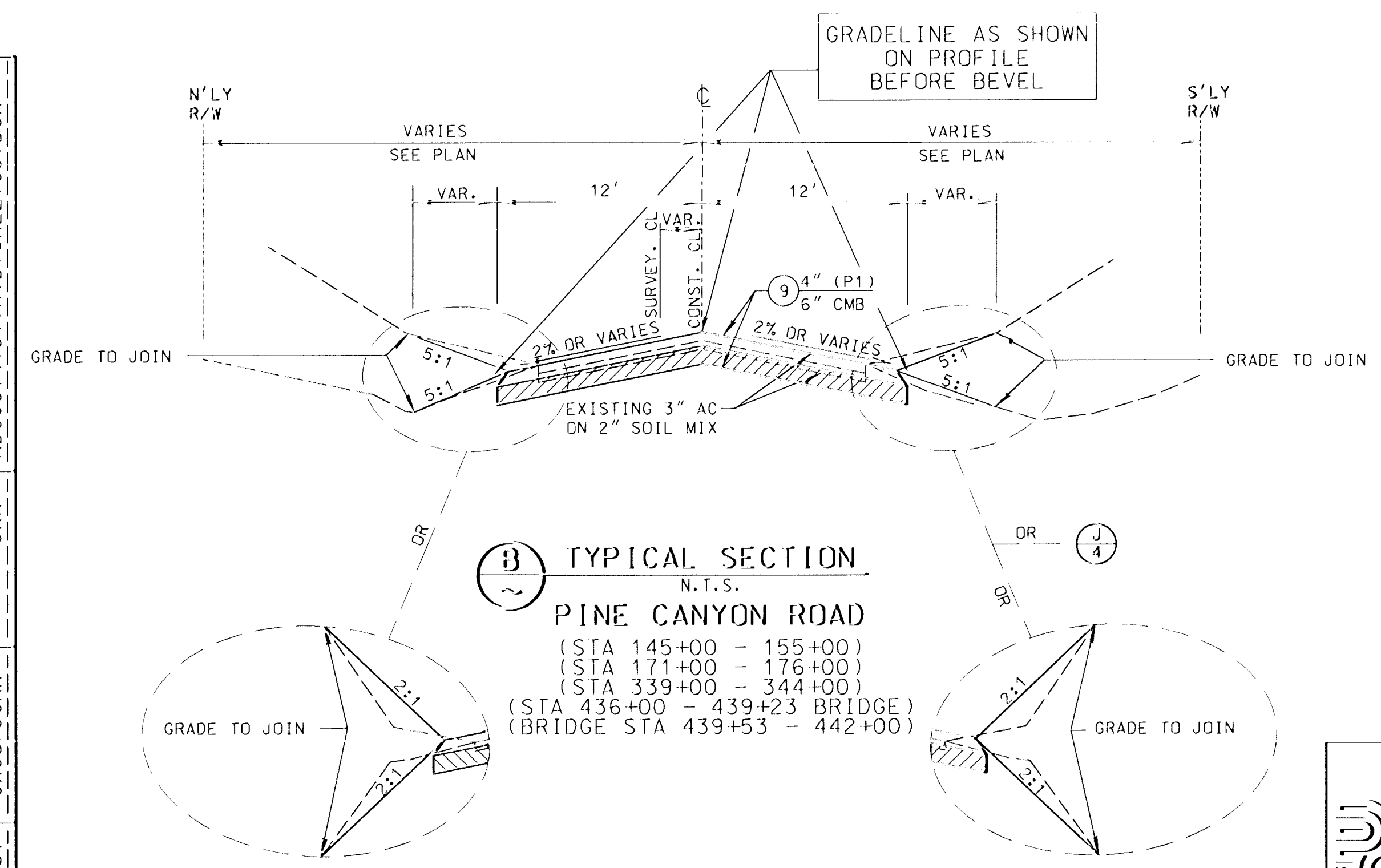
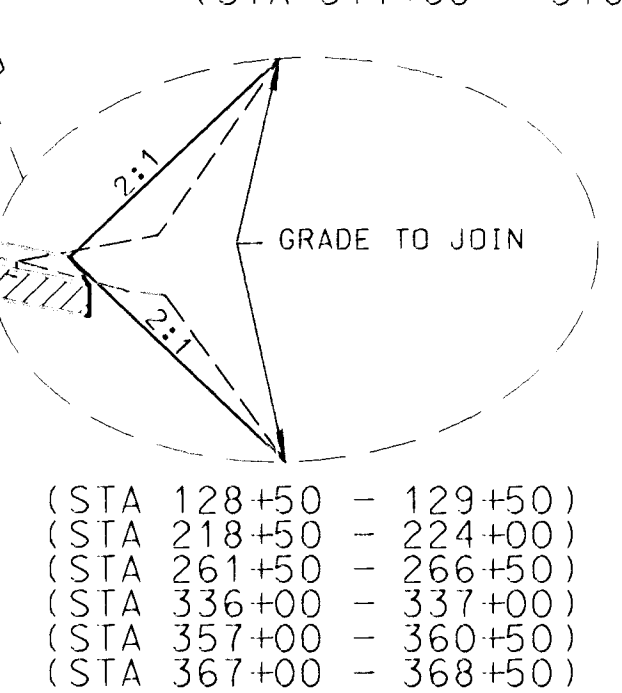

CAD PROJECT FILE NAME: RDC0014131-HYD-SHEET 03.DGN
 CHECKER: JKR
 DESIGNER: CXCO/JGRH
 DRAFTER: A.P./MMST

DAVID EVANS AND ASSOCIATES INC.
 800 North Haven Avenue, Suite 300
 Ontario California 91764
 Phone: 909.481.5750

TWO DAYS BEFORE YOU DIG
 CALL USA TOLL FREE
 1-800-227-2600

DATE	MK	DESCRIPTION

REGISTERED PROFESSIONAL ENGINEER
 JEFFREY K. RUPP
 No. 42868
 exp. 3/31/2004
 CIVIL
 STATE OF CALIFORNIA

COUNTY OF LOS ANGELES DEPARTMENT OF PUBLIC WORKS
PINE CANYON ROAD
 "THREE POINTS ROAD TO LAKE HUGHES ROAD"
 TYPICAL SECTIONS & DETAILS
 PROJECT ID NO. RDC0014131

PCA X2509653 DWG SHEET 3 OF 53