

LOS ANGELES COUNTY PUBLIC WORKS

SOUTH WHITTIER LOS NIETOS

KEITH DRIVE, ET AL.

INDEX TO PROJECT PLANS

SHEET NUMBER	DESCRIPTION
1	TITLE SHEET
2	CONSTRUCTION NOTES AND REFERENCES
3	TYPICAL SECTIONS
4	TYPICAL SECTIONS
5-67	PLAN AND PROFILE
68-74	PARKWAY IMPROVEMENT TABLES
75-76	DETAILS
77-79	PLAN, TYPICAL SECTIONS, AND DETAILS
PLAN TC	TRAFFIC CONTROL PLANS

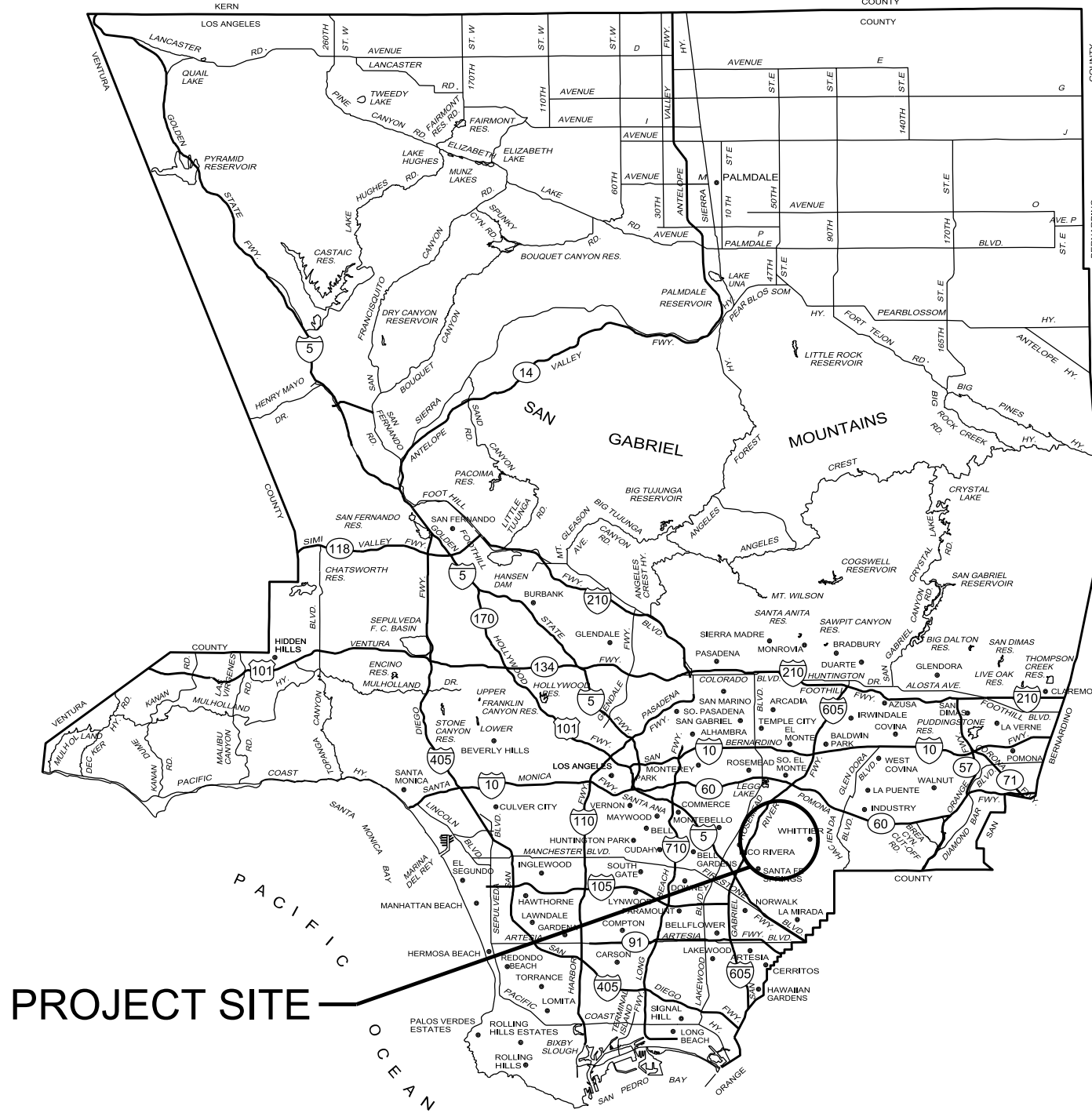

PROJECT SITE

T.G. 676 J5-J6; 677 A5-7, B6;
707 E4-5, F4-5
R.D. 446

LOCATION MAP
NOT TO SCALE

PROJECT LIMITS	SHEET #
Glengarry Avenue - Mines Boulevard to Whittier Boulevard	5, 6, 7
Boer Avenue - Mines Boulevard to Rose Hedge Drive	8
Boer Avenue - Reichling Lane to Loch Avon Drive	9, 10
Duchess Drive - Mines Boulevard to See Drive	11, 12, 13
Dorland Place - See Drive to Whittier Boulevard	14
Vanport Avenue - Mines Boulevard to Hadley Street	15, 16
Thornlake Avenue - Bexley Drive to Loch Lomond Drive	17
Western Avenue - Loch Lomond Drive to Rincon Drive	18
Western Avenue - See Drive to Whittier Boulevard	18
Gretna Avenue - Rose Hedge Drive to Whittier Boulevard	19, 20, 21
Glencannon Drive - Norwalk Boulevard to Loch Avon Drive	22
See Drive - Glengarry Avenue to 100' e/o Dorland Place	23
See Drive - Broadway to Gretna Avenue	24, 25
Rincon Drive - Glengarry Avenue to Gretna Avenue	26, 27, 28
Keith Drive - Rincon Drive to Broadway	29
Keith Drive - Hadley Street to Gretna Avenue	30, 31
Loch Avon Drive - Norwalk Boulevard to Glengarry Ave	32, 33
Loch Avon Drive - Glengarry Ave to Hadley St	34
Bexley Drive - Norwalk Boulevard to Glengarry Avenue	35, 36
Townley Drive - Norwalk Boulevard to Glengarry Avenue	37, 38
Reichling Lane - Norwalk Boulevard to Broadway	39, 40, 41
Aldrich Street - 460' w/o Glengarry Avenue to Glengarry Avenue	42
Vicki Drive - Aldrich Street to 280' n/o Aldrich Street	42
Townley Drive - 190' w/o Boer Avenue to Boer Avenue	43
Rose Hedge Drive - Glengarry Avenue to Boer Avenue	43
Rose Hedge Drive - 260' w/o Duchess Drive to Duchess Drive	44
Bradhurst Street - 260' w/o Duchess Drive to Duchess Drive	44
Aldrich Street - 260' w/o Duchess Drive to Duchess Drive	45
Loch Lomond Drive - Thornlake Avenue to Gretna Avenue	46, 47
Havenwood Drive - Thornlake Avenue to Gretna Avenue	48, 49
Bexley Drive - Broadway to Gretna Avenue	50, 51
Hadley Street - Glengarry Avenue to Broadway	52, 53
Alley s/o Hadley Street - Keith Drive to Prather Avenue	54, 55
Alley n/o See Drive - Alley s/o Hadley Street to Gretna Avenue	55
Alley s/o See Drive - Alley s/o Hadley Street to Gretna Avenue	56
Alley s/o Rincon Drive - Western Avenue to Gretna Avenue	57
Lanning Drive - Mills Avenue to Regatta Avenue	58
Mills Avenue East frontage road - Lanning Drive to 350' n/o Lanning Drive	58
Elmore Avenue - Lanning Drive to 380' n/o Lanning Drive	59
Regatta Avenue - Lanning Drive to 400' n/o Lanning Drive	60
Terryknoll Drive - Victoria Avenue to Ruoff Avenue	61
Mulberry Drive North frontage road - Victoria Avenue to Ruoff Avenue	62
Regatta Avenue - 510' s/o Mulberry Drive to Mulberry Drive	63
Ruoff Avenue - 415' s/o Mulberry Drive to Mulberry Drive	64
Mulberry Drive South frontage road - Ruoff Avenue to 155' e/o Ruoff Avenue	64
Corley Drive - Danbrook Drive to Lanning Drive	65
Corley Drive - Dunton Drive to 450' n/o Dunton Drive	66
Dunton Drive - Valley View Avenue to Colima Road	67
Leffingwell Road - 200' w/o Kibbee Avenue to 160' e/o Kibbee Avenue	77, 78, 79

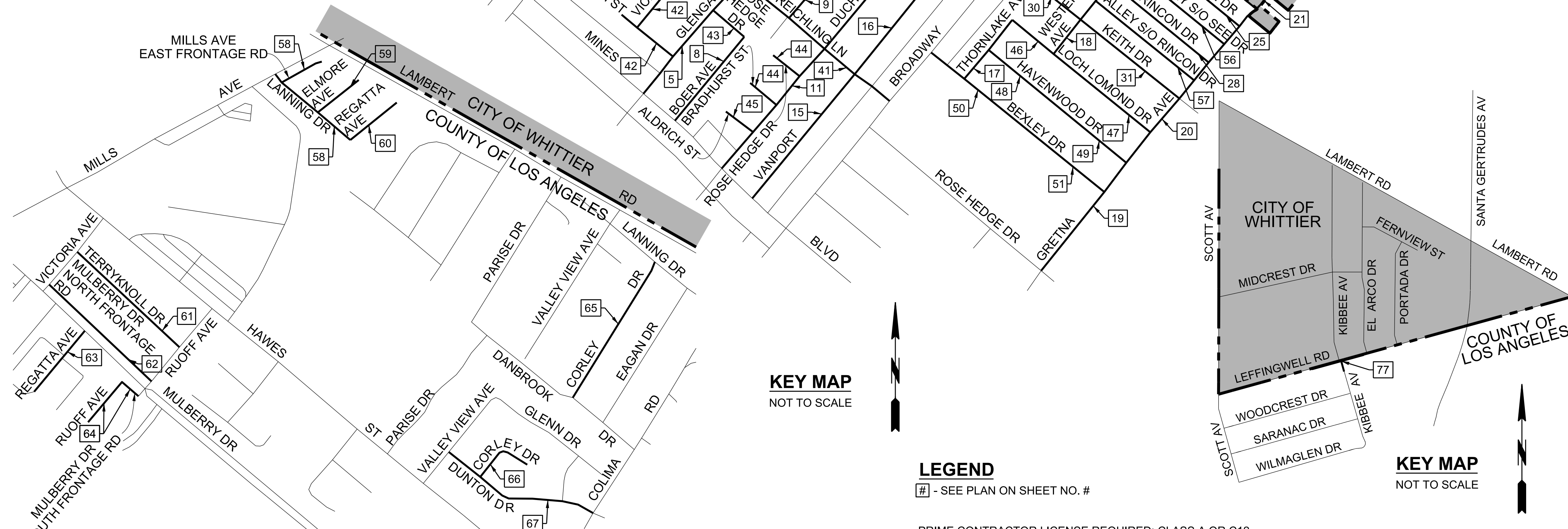

KEY MAP
NOT TO SCALE

LEGEND

- SEE PLAN ON SHEET NO.

PRIME CONTRACTOR LICENSE REQUIRED: CLASS A OR C12

CADD PROJECT FILE NAME: RMD4408001-PLAN-RD.DGN
CHECKER: B. FUNG
DESIGNER: J. GARCIA
DRAFTER: J. GARCIA

KEY MAP
NOT TO SCALE



Know what's below.
Call before you dig.

APPROVED BY: *[Signature]* 7/17/19
CITY OF WHITTIER DATE

APPROVED BY: *[Signature]* 07/22/2019
DEPUTY DIRECTOR DATE

RECOMMENDED BY: *[Signature]* 07/22/2019
ASSISTANT DEPUTY DIRECTOR DATE

SUBMITTED BY: *[Signature]* 7-18-19
DESIGN TEAM II DATE

DATE	MARK	DESCRIPTION
10/25/2021	AS-BUILT	
REVISIONS		

REGISTERED PROFESSIONAL ENGINEER
BRIAN FUNG
C 76772
CIVIL
STATE OF CALIFORNIA
PROJECT ENGINEER
[Signature] 6/24/19
DATE

LOS ANGELES COUNTY PUBLIC WORKS

SOUTH WHITTIER LOS NIETOS

KEITH DRIVE, ET AL.

PROJECT ID NO. RMD4408001

TITLE SHEET

PD PH086520 SHEET 1 OF 79