

TYPICAL SECTION

NO SCALE

ALLEY S/O HADLEY ST - KEITH DR TO ALLEY N/O SEE DR
 ALLEY S/O RINCON DR - WESTERN AVE TO GRETNA AVE
 ALLEY S/O SEE DR - ALLEY S/O HADLEY ST TO GRETNA AVE

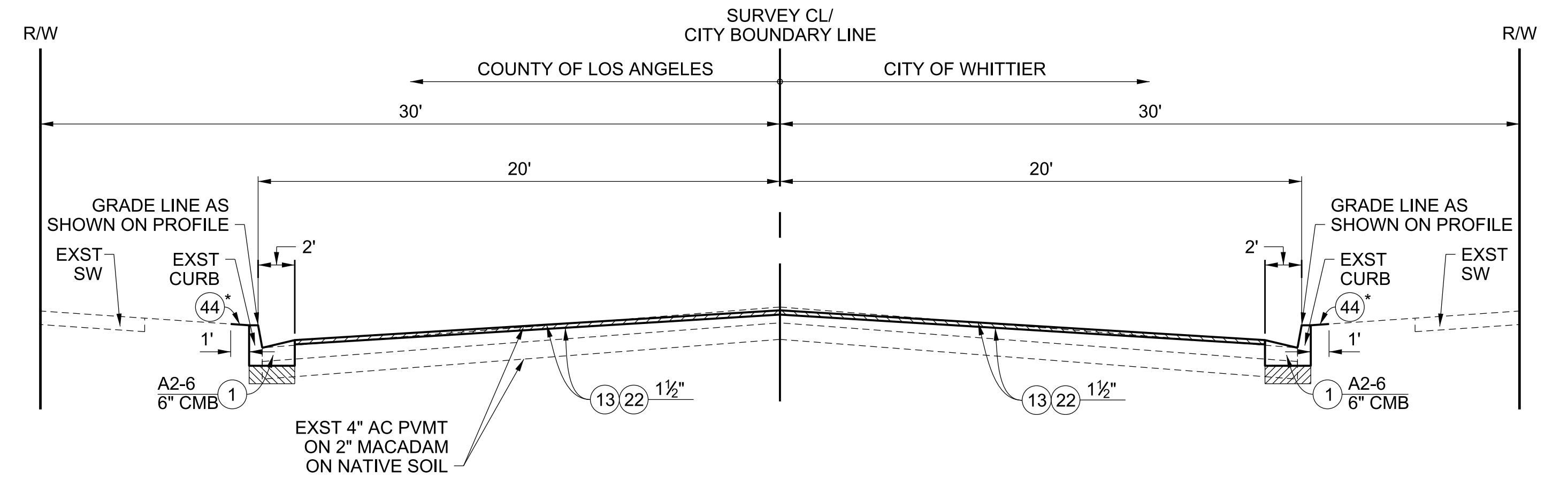

TYPICAL SECTION

NO SCALE

GRETNA AVE - 735' N/O KEITH DR TO 810' N/O KEITH DR

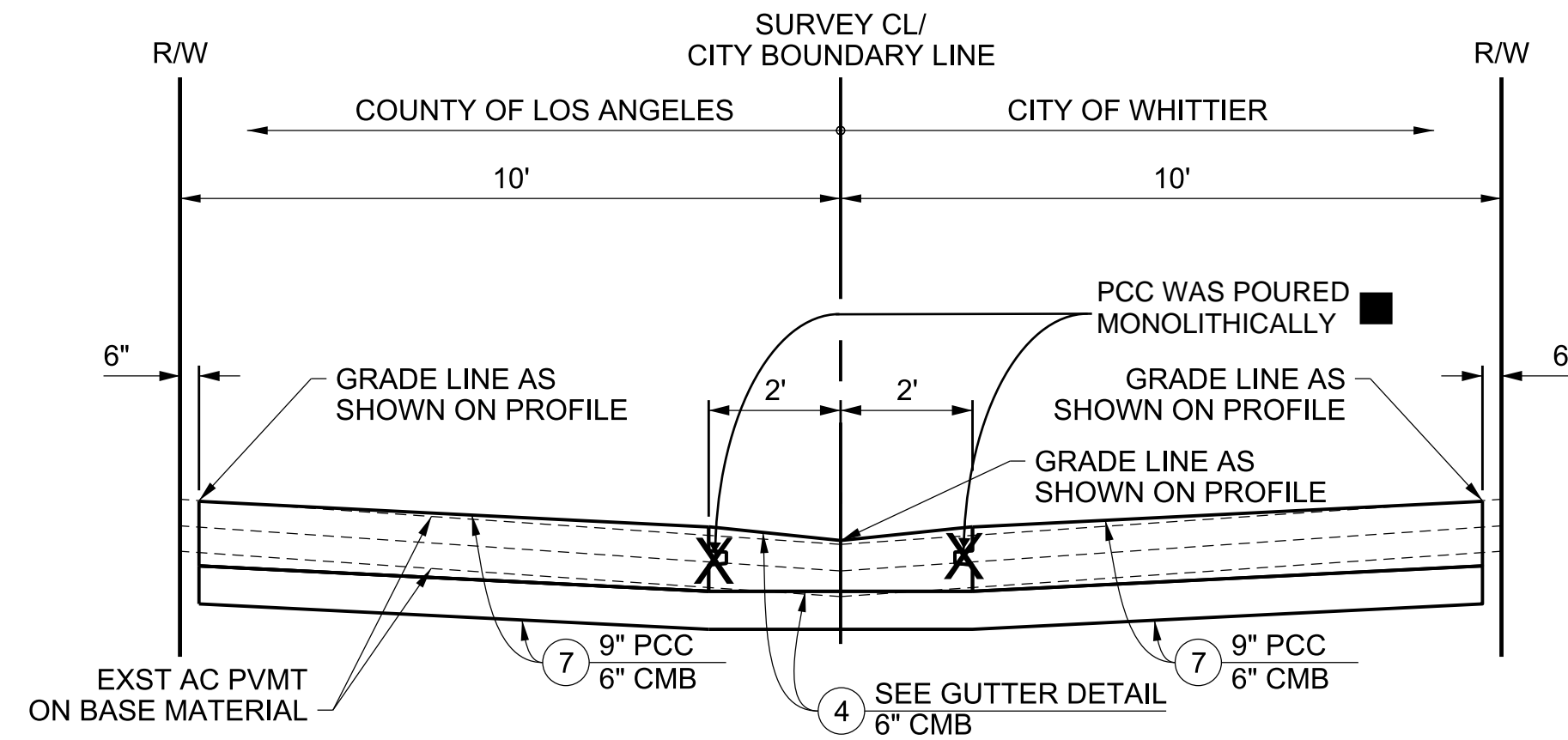

TYPICAL SECTION

NO SCALE

ALLEY S/O HADLEY ST - ALLEY N/O SEE DR TO PRATHER AVE
 ALLEY N/O SEE DR - GRETNA AVE TO ALLEY S/O HADLEY ST

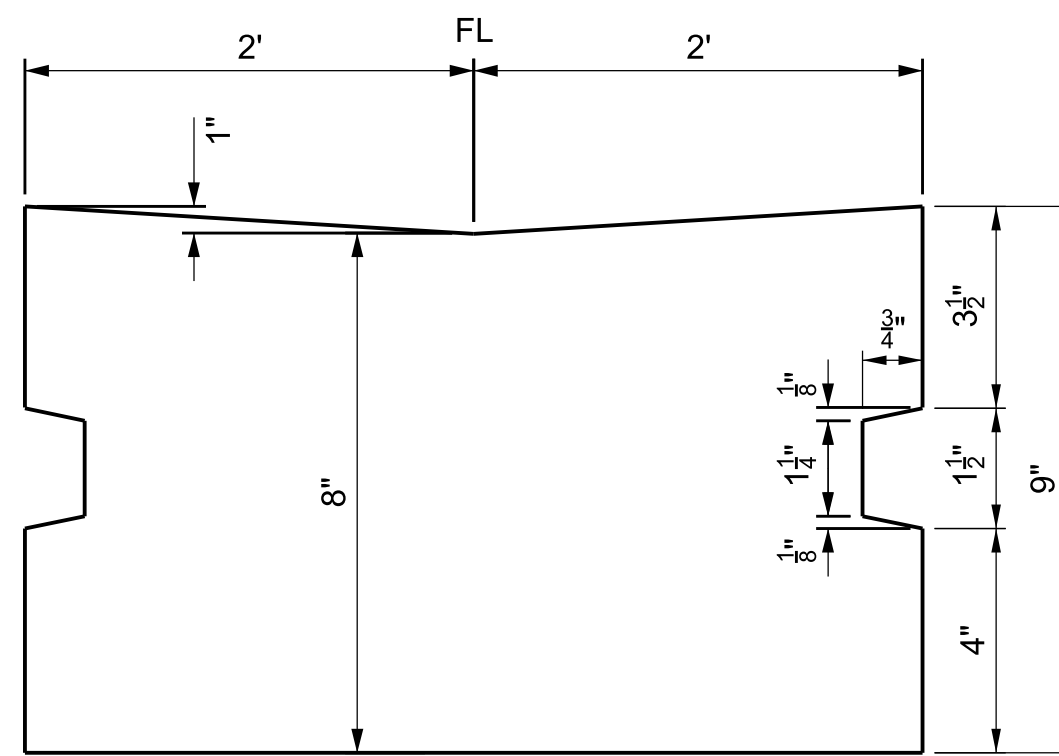

GUTTER DETAIL

NO SCALE

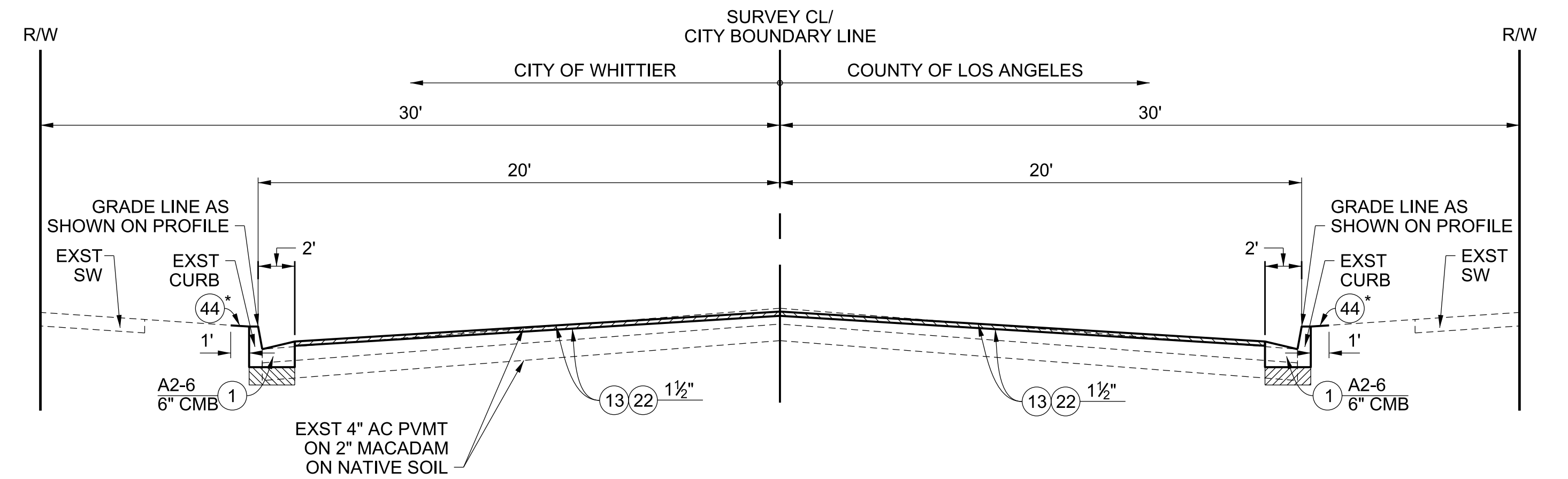

TYPICAL SECTION

NO SCALE

GRETNA AVE - 810' N/O KEITH DR - PRATHER AVE

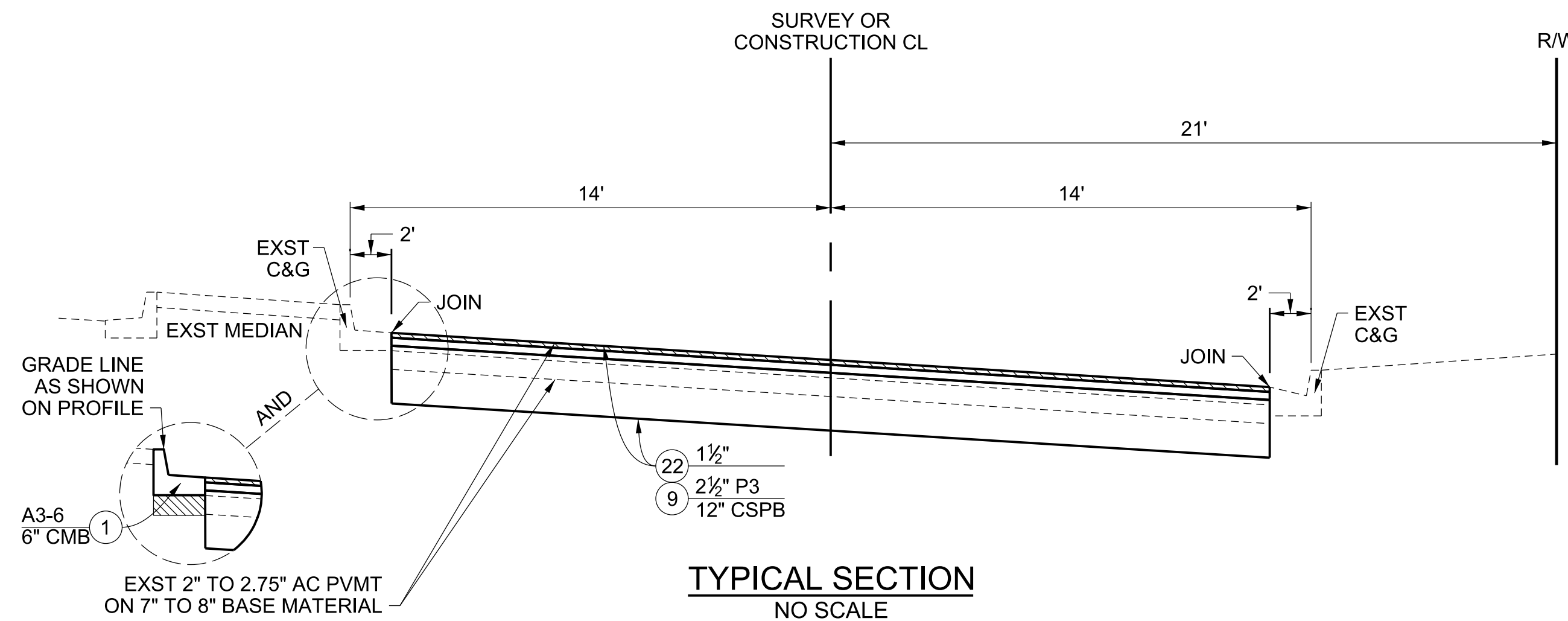

TYPICAL SECTION

NO SCALE

MULBERRY DR NORTH FRONTAGE RD - RUOFF AVE TO VICTORIA AVE
 MULBERRY DR SOUTH FRONTAGE RD - RUOFF AVE TO 155' E/O RUOFF AVE
 MILLS AVE EAST FRONTAGE RD - LANNING DR TO 350' N/O LANNING DR

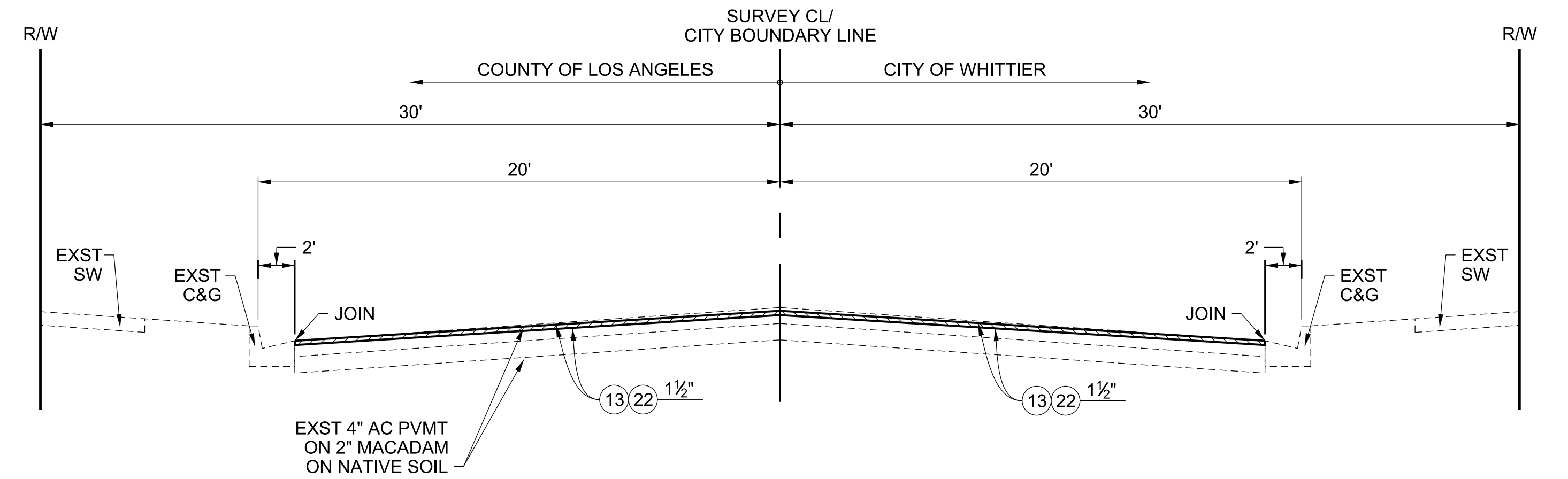

TYPICAL SECTION

NO SCALE

GRETNA AVE - PRATHER AVE TO HADLEY ST

CADD PROJECT FILE NAME
 RMD4408001-PLAN-RD.DGN
 CHECKER
 B. FUNG
 DESIGNER
 J. GARCIA
 DRAFTER
 J. GARCIA

* TYPE OF SOD INSTALLED SHALL BE MARATHON OR ST. AUGUSTINE TO MATCH EXISTING.

				LOS ANGELES COUNTY PUBLIC WORKS SOUTH WHITTIER LOS NIETOS KEITH DRIVE, ET AL. PROJECT ID NO. RMD4408001 TYPICAL SECTIONS	
10/25/2021	AS-BUILT				
DATE	MARK	DESCRIPTION	PROJECT ENGINEER	DATE	
REVISIONS					