

SCALE: HOR. 1"= 40'
VERT. 1"= 8'

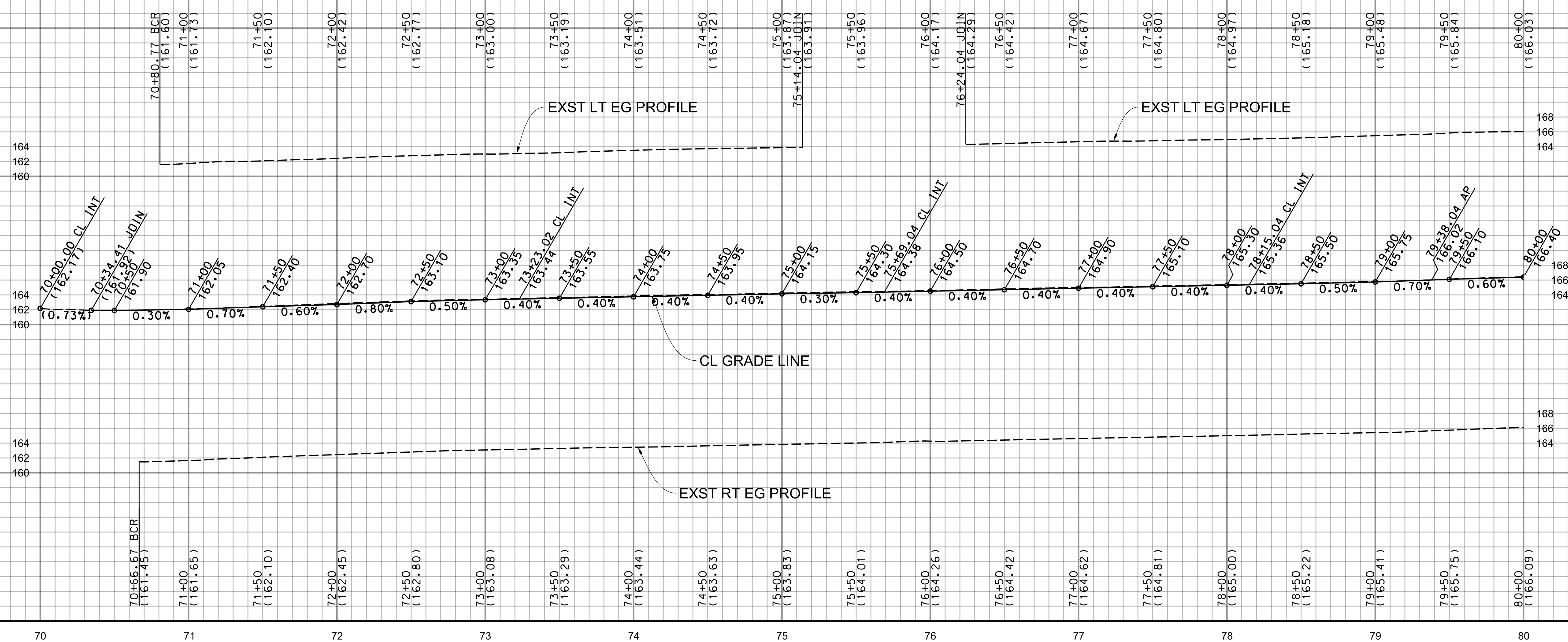

SEE SHEET 68 FOR PARKWAY IMPROVEMENTS

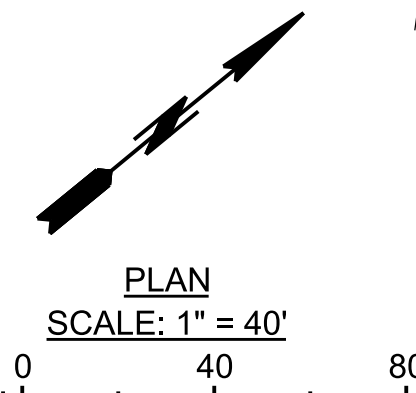
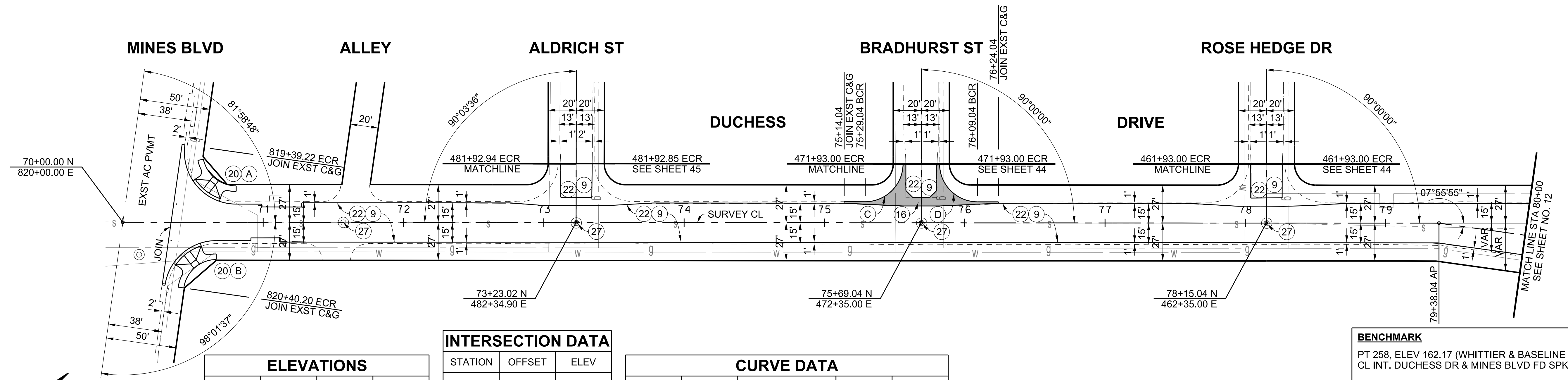

ELEVATIONS			
CURVE	BCR	Δ/2	ECR
(A)	162.11 TC	162.22 TC	161.94 TC
	161.44 FL	161.55 FL	161.27 FL
(B)	161.97 TC	162.14 TC	161.93 TC
	161.30 FL	161.47 FL	161.26 FL
(C)	164.53 TC	164.60 TC	164.67 TC
	163.86 FL	163.93 FL	164.00 FL
(D)	164.85 TC	164.73 TC	164.73 TC
	164.18 FL	164.07 FL	164.06 FL

INTERSECTION DATA		
STATION	OFFSET	ELEV
70+38.28	13' LT	161.83
70+34.58	13' RT	161.74
75+56.04	15' LT	163.93
75+69.04	15' LT	163.96
75+82.04	15' LT	163.99

CURVE DATA				
CURVE	RADIUS	CENTRAL ANGLE	LENGTH	TANGENT
(A)	35.00'	98° 01' 12"	59.88'	40.28'
(B)	35.00'	81° 58' 23"	50.07'	30.41'
(C)	27.00'	90° 00' 00"	42.41'	27.00'
(D)	27.00'	90° 00' 00"	42.41'	27.00'

BENCHMARK
PT 258, ELEV 162.17 (WHITTIER & BASELINE QUAD 2005), PWFB 1026, PG 2179
CL INT. DUCHESS DR & MINES BLVD FD SPK & W PER R4, FL



LOS ANGELES COUNTY PUBLIC WORKS
SOUTH WHITTIER LOS NIETOS
KEITH DRIVE, ET AL.
PROJECT ID NO. RMD4408001
PLAN AND PROFILE

DATE	MARK	DESCRIPTION
10/25/2021	AS-BUILT	
REVISIONS		

PROJECT ENGINEER: R.S. (Signature)
DATE: 6/24/19