

SCALE: HOR. 1"= 40'
VERT. 1"= 8'

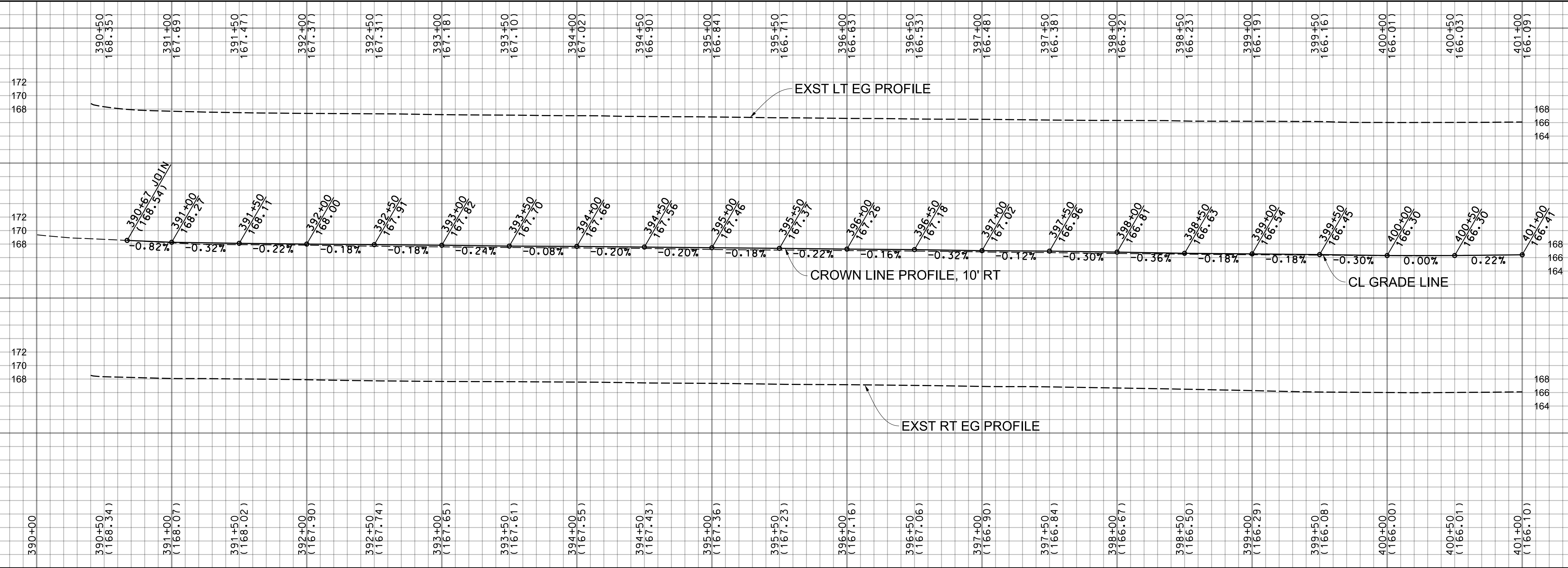

SEE SHEET 73 FOR PARKWAY IMPROVEMENTS

NORWALK BLVD

REICHLING LN

LN

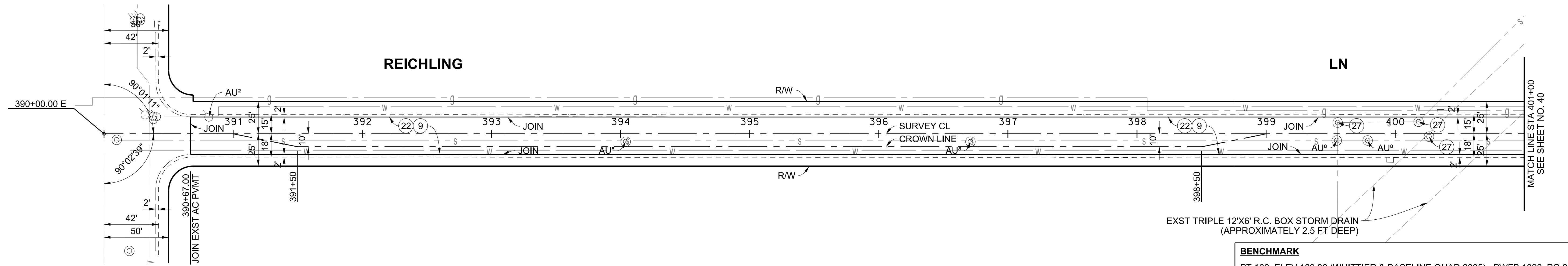

BENCHMARK
PT 166, ELEV 169.36 (WHITTIER & BASELINE QUAD 2005), PWFB 1026, PG 2130
CL INT REICHLING LN & NORWALK BLVD FD S&W FL PER R1

LOS ANGELES COUNTY PUBLIC WORKS

SOUTH WHITTIER LOS NIETOS
KEITH DRIVE, ET AL.

PROJECT ID NO. RMD4408001
PLAN AND PROFILE

PD PH086558 SHEET 39 OF 79

THE CONTRACTOR SHALL EXERCISE EXTREME CAUTION WHEN EXCAVATING FROM NORWALK BOULEVARD TO BROADWAY ON REICHLING LANE DUE TO THE SHALLOW SEWER. THE SEWER LINE IS APPROXIMATELY 3.5 FT TO 5 FT DEEP. THE CONTRACTOR SHALL LIMIT CONSTRUCTION EQUIPMENT LOADING DIRECTLY OVER THE SEWER DURING CONSTRUCTION.

DATE	MARK	DESCRIPTION
10/25/2021	AS-BUILT	
REVISIONS		



PROJECT ENGINEER: *R.S.* DATE: 6/24/19

