

SCALE: HOR. 1"= 40'  
VERT. 1"= 8'

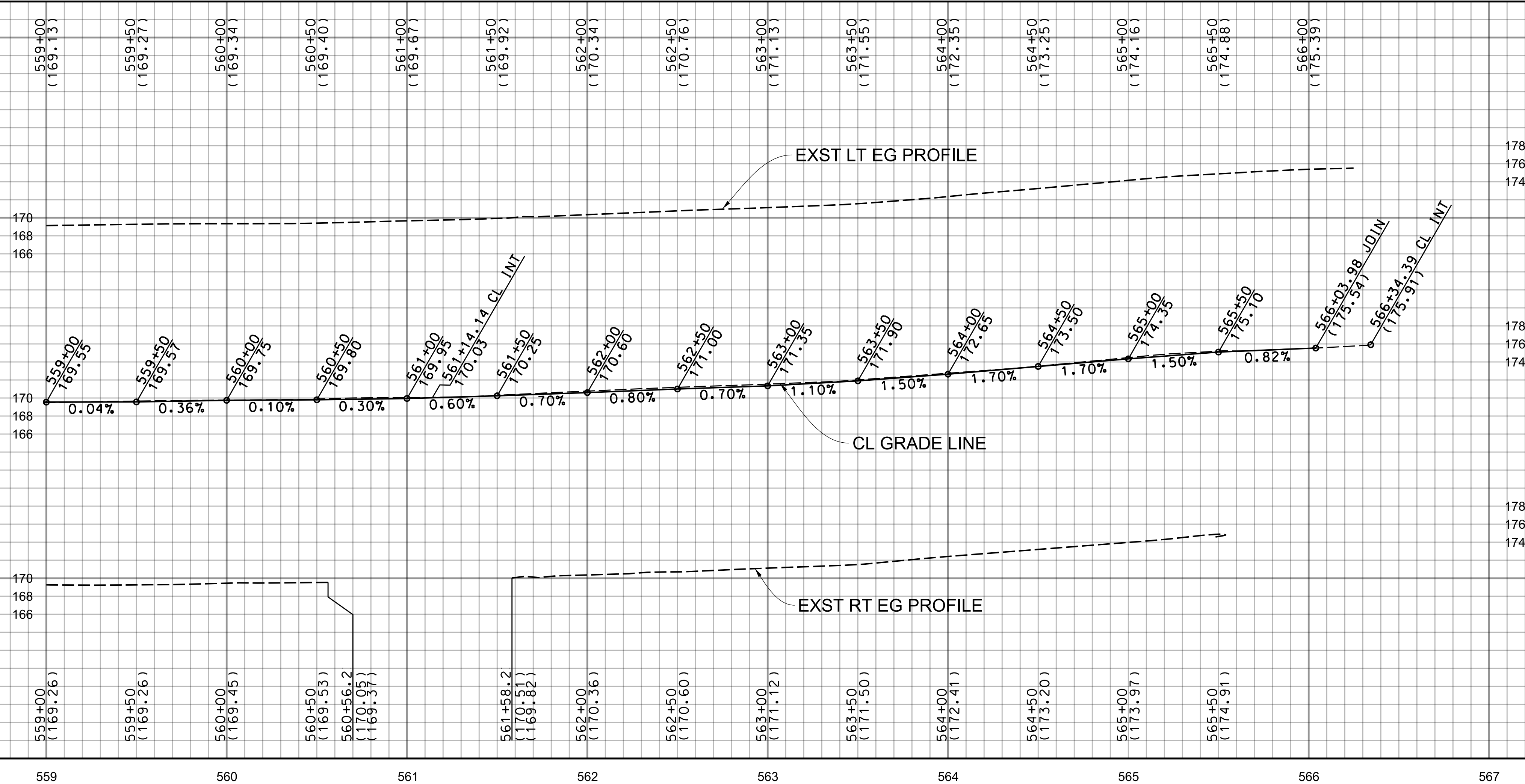

SEE SHEET 75 FOR PARKWAY IMPROVEMENTS

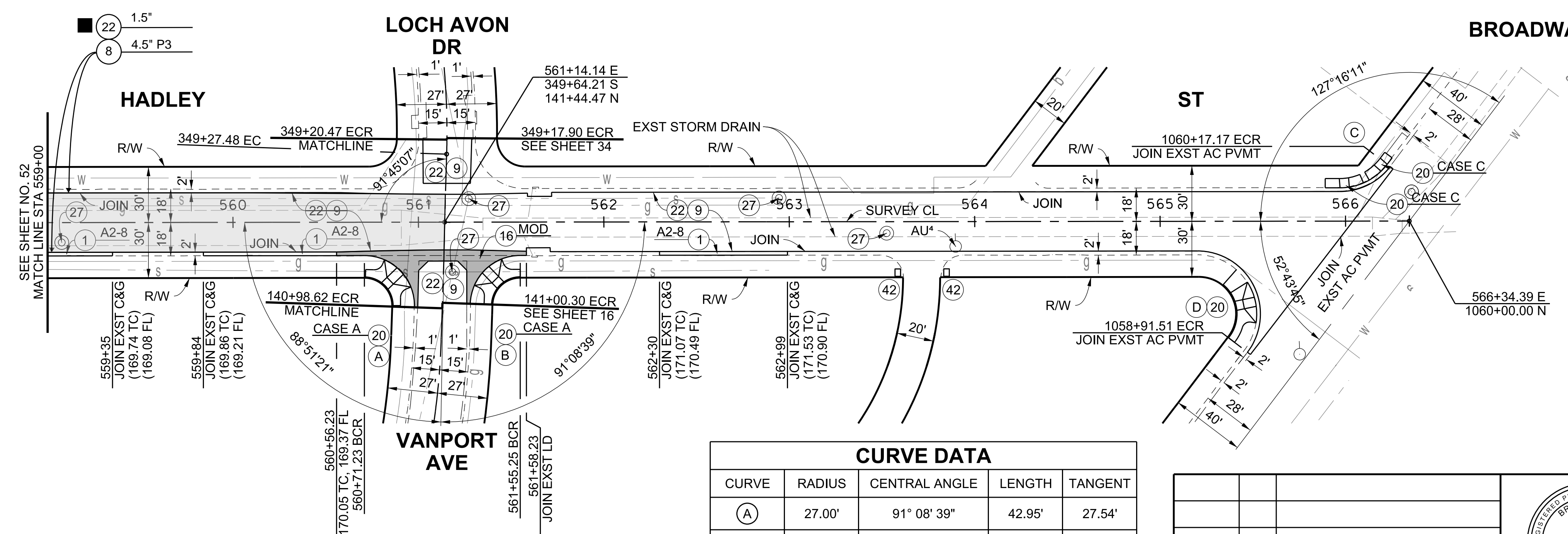

ELEVATIONS			
CURVE	BCR	Δ/2	ECR
(A)	170.02 TC 169.35 FL	170.18 TC 169.51 FL	170.32 TC 169.65 FL
(B)	170.43 TC 169.76 FL	170.38 TC 169.71 FL	170.39 TC 169.72 FL
(C)	175.82 TC 175.15 FL	176.02 TC 175.35 FL	176.02 TC 175.35 FL
(D)	174.82 TC 174.15 FL	175.37 TC 174.70 FL	175.02 TC 174.35 FL

INTERSECTION DATA		
STATION	OFFSET	ELEV
560+98.78	18' RT	169.53
561+13.78	18' RT	169.61
561+28.78	18' RT	169.67
566+13.90	16' LT	175.50
565+88.95	16' RT	175.34

CURVE DATA				
CURVE	RADIUS	CENTRAL ANGLE	LENGTH	TANGENT
(A)	27.00'	91° 08' 39"	42.95'	27.54'
(B)	27.00'	88° 51' 21"	41.87'	26.47'
(C)	32.00'	52° 43' 49"	29.45'	15.86'
(D)	32.00'	127° 16' 15"	71.08'	64.56'

**BENCHMARK**  
PT 16197, ELEV ??? (WHITTIER & BASELINE QUAD 2005), PWFB 1026, PG 2195  
CL INT. HADLEY ST & 2ND ALLEY W/O BROADWAY EST. AT REC. DIST. PER R3,  
NOTH. FD/SET



LOS ANGELES COUNTY PUBLIC WORKS  
**SOUTH WHITTIER LOS NIETOS**  
KEITH DRIVE, ET AL.  
PROJECT ID NO. RMD4408001  
PLAN AND PROFILE

DATE	MARK	DESCRIPTION
10/25/2021	AS-BUILT	
REVISIONS		

PROJECT ENGINEER: R. S. G. / 6/24/17